

Specification – Marmox Fireboard as a plastered, insulating board on a masonry wall

Product Ref: Marmox Fireboard

Application: Plasterable IWI substrate offering thermal, acoustic and breathable fireproof insulation to an internal masonry or aircrete wall

Manufacturer: Marmox Ltd

Address: Marmox UK Ltd, Caxton House, 101 Hopewell Drive, Chatham, Kent ME5 7NP.
01634 835290; Email: sales@marmox.co.uk; <http://www.marmox.co.uk/>.

Description: A dense core of mineral wool covered on both sides with fibreglass mesh encased in a c.1.0mm layer of polymer modified concrete permanently bonded to the mineral wool core.

Dimensions: Width = 600mm, Length = 1200mm, Thickness = 12, 20, 50, 100mm

Properties: Low thermal conductivity (0.037W/mK), vapour permeable ($\mu=3.85$) and acoustic insulation Certified (BRE) as completely non-combustible (Class A1)

UKCA mark: Declaration of Performance for a Mineral Wool Insulation Board to EN13162: 2012

Fixing Method: The board is fixed directly on to a flat masonry, brick or concrete wall with EIGHT mechanical fixings.

For mechanical fixing to a wall, the wall's variation in flatness should be <10mm over a 2m span. *If it is greater either: -*

- a) the wall should be made level by applying render or plaster.*
- b) Fix onto wooden battens.*

- Determine the location of the boards, they can be aligned vertically or horizontally ideally in a staggered (*Brick-bond*) format.

The boards will eventually be fixed either with: -

- a)** Eight insulation support anchors, as shown, 2-3cm in from the edge; three down each long edge, two down the middle. *The length of these anchors must ensure there is at least 40mm impregnation into the concrete. Drill out using an 8mm masonry drill bit.*
- b)** Eight screws and metal washers, as shown, 2-3cm in from the edge
- c)** Eight thermal block fixings and washers, as shown, 2-3cm in from the edge with aircrete/thermal block.

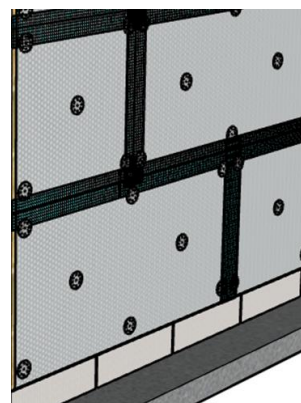

- If the board is abutting a wall or ceiling, apply a line of intumescent sealant along the edge of the mineral wool layer so that when in position, it is sealing the mineral wool slab to the wall.
- Before putting up the next board, apply a line of intumescent sealant along the edge of the board already in place so that it seals with the adjacent board. *One 300ml tube will typically be sufficient for approximately three to four panels.*

Specification – Marmox Fireboard as a plastered, insulating board on a masonry wall

Plastering: The board surface is cement based with low porosity so does not need priming.

Any exposed (*mineral wool*) edges should be covered with beading prior to plastering.

- Scrim tape (*Marmox reinforcing tape*) is applied over all joints
- Dampen the surface of the Marmox board.
- Apply two coats of plaster – the first onto the Marmox board surface approximately 2mm thick and a further 1mm approximately one hour later.

Notes: **1)** To achieve a resistance to impact commensurate with 'Medium Duty performance' of plasterboard (*as defined by BS5234*) An additional layer of fibreglass scrim must be added between the two applications of plaster. This additional scrim layer is not necessary when only 'Light Duty performance' is required.

2) When used on walls, a single skim coating of plaster on Marmox Fireboard is not recommended.